

---

# Sequential Behavior of Broiler Chickens in Enriched Environments Under Varying Thermal Conditions Using the Generalized Sequential Pattern Algorithm: A Proof of Concept

---

Juliana M. Massari , [Daniella J. Moura](#) <sup>\*</sup> , [Irenilza A. Nääs](#) , [Danilo F. Pereira](#) , [Stanley R. M. Oliveira](#) , [Tatiane Branco](#) , Juliana de S. G. Barros

Posted Date: 12 June 2024

doi: 10.20944/preprints202406.0826.v1

Keywords: animal behavior; animal welfare; data mining; environment; machine learning; precision livestock farming



Preprints.org is a free multidiscipline platform providing preprint service that is dedicated to making early versions of research outputs permanently available and citable. Preprints posted at Preprints.org appear in Web of Science, Crossref, Google Scholar, Scilit, Europe PMC.

Copyright: This is an open access article distributed under the Creative Commons Attribution License which permits unrestricted use, distribution, and reproduction in any medium, provided the original work is properly cited.

Article

# Sequential Behavior of Broiler Chickens in Enriched Environments under Varying Thermal Conditions Using the Generalized Sequential Pattern Algorithm: A Proof of Concept

Juliana M. Massari <sup>1</sup>, Daniella J. Moura <sup>2</sup>, Irenilza A. Nääs <sup>3,\*</sup>, Danilo F. Pereira <sup>4</sup>, Stanley R. M. Oliveira <sup>5</sup>, Tatiane Branco <sup>6</sup> and Juliana de S. G. Barros <sup>7</sup>

<sup>1</sup> School of Agricultural Engineering, State University of Campinas, 501 Candido Rondon Avenue, 13083-875, Campinas, São Paulo, Brazil; jujumassari@gmail.com

<sup>2</sup> School of Agriculture Engineering, Campinas, São Paulo, Brazil; djmoura@unicamp.br

<sup>3</sup> Graduate Program in Production Engineering, Paulista University, R. Dr. Bacelar 1212, 04026-002, São Paulo, Brazil

<sup>4</sup> Department of Management, Development and Technology, School of Science and Engineering, São Paulo State University, São Paulo, Brazil; danilo.florentino@unesp.br

<sup>5</sup> Embrapa Agricultural Informatics, State University of Campinas, 209 Andre Tosello, 13083-886, Campinas, São Paulo, Brazil, stanley.oliveira@embrapa.br

<sup>6</sup> Agricultural and Forestry/Animal Scientist Analyst, Secretariat of Agriculture, Livestock, Sustainable Production, and Irrigation – SEAPI, 1384 Getulio Vargas Avenue, Porto Alegre, Rio Grande do Sul, Brazil, tatibranco91@gmail.com

<sup>7</sup> School of Agricultural Engineering, State University of Campinas, 501 Candido Rondon Avenue, 13083-875, Campinas, São Paulo, Brazil, jgbarros@unicamp.br

\* Correspondence: irenilza.naas@docente.unip.br

**Simple Summary:** Animal production workers routinely use postural and behavioral patterns to assess thermal comfort and assist in environmental management. The analysis of behavior sequences was investigated in broiler chickens housed in enriched environments subjected to thermal comfort and heat stress using the Generalized Sequential Pattern (GSP) data mining algorithm. The comfort temperature resulted in a greater number of behavioral patterns compared to heat stress. Heat is a limiting factor for the occurrence of patterns, restricting movement and decreasing the group's activity level. GSP identified temporal correlations between heat stress and the behavior of broiler chickens in enriched environments and can be an efficient alternative for monitoring and possibly diagnosing heat stress.

**Abstract:** Behavior analysis is a widely used non-invasive tool in the practical production routine, as the animal acts as a biosensor capable of reflecting its degree of adaptation and discomfort to some environmental challenge. Predominantly, conventional statistics use occurrence data for behavioral evaluation and well-being estimation, disregarding the temporal sequence of events. The Generalized Sequential Pattern (GSP) algorithm is a data mining method that identifies recurrent sequences that exceed a user-specified support threshold, whose potential has not yet been investigated for broiler chickens in enriched environments. Enrichment aims to increase environmental complexity with promising effects on animal welfare, stimulating priority behaviors and potentially reducing the deleterious effects of heat stress. The objective was to validate the application of the GSP algorithm to identify temporal correlations between heat stress and the behavior of broiler chickens in enriched environments through proof of concept. Video image collection was carried out automatically for 48 continuous hours, analyzing a continuous period of seven hours, from 12:00 PM to 6:00 PM, during two consecutive days of tests for chickens housed in enriched and non-enriched environments under comfort and stress temperatures. Chickens at comfort temperature showed high motivation to perform the behaviors of Preening (P), Foraging (F), Lying down (Ld), Eating (E), and Walking (W) whose sequences  $\langle \{Ld,P\} \rangle$ ;  $\langle \{Ld,F\} \rangle$ ;  $\langle \{P,F,P\} \rangle$ ;

<{Ld,P,F}> and <{E,W,F}> were the only ones observed in both treatments. All other sequential patterns (comfort and stress) were distinct, suggesting that environmental enrichment alters the behavioral pattern of broiler chickens. Heat stress drastically reduced the sequential patterns found at the 20% threshold level in the tested environments. The behavior of lying laterally “LI” is a strong indicator of heat stress in broilers and was only frequent in the non-enriched environment, which may suggest that environmental enrichment provides the animal with better opportunities to adapt to stress-inducing challenges, such as heat.

**Keywords:** animal behavior; animal welfare; data mining; environment; machine learning; precision livestock farming

---

## 1. Introduction

Chicken meat is distinguished by being a low-cost, high-quality source of protein, and it is considered one of the most environmentally friendly meats to produce. [1]. In traditional livestock farming, decision-making criteria primarily rely on the producer’s experiential and empirical knowledge [2]. In the routine management practices of farmers, particular attention is paid to broiler chickens’ behavioral activity and spatial occupancy patterns during visual inspection. This process demands a considerable amount of time.[3]. In precision livestock farming (PLF), decision-making relies on quantitative data obtained through process engineering principles and techniques. Such an approach enables the automatic monitoring, modeling, and management of animal production. [4]. Therefore, in precision livestock farming (PLF), technologies enable the continuous collection of behavioral and physiological data at the individual level [5], allowing for the automated and real-time monitoring of critical indicators of herd behavior.

The substantial collection and storage of data in smart agricultural production have presented a new challenge: how can this large volume of data be processed to derive actionable insights for optimizing animal production? This situation introduces an additional layer of complexity, which can be addressed by applying machine learning and data mining techniques [6].

Recent technologies for monitoring farm animals rely on computer vision and machine learning algorithms [2]. The application of digital image processing and machine learning has facilitated a rise in research focused on avian welfare [7]. The goal of environmental enrichment is to enhance environmental complexity. [8] providing opportunities for animals to perform natural behaviors [9], changing broiler behavior and distribution patterns [10–15].

Among all environmental stressors, thermal stress is the most harmful, with great emphasis on animal agriculture. [16]. When exposed to heat stress, broilers exhibit behavioral, immunological, and physiological changes that negatively impact their overall productivity [17]. Husbandry workers routinely observe animal postural patterns to assess thermal comfort and adjust environmental settings or management. [18]. Environmental enrichment during early age (1 to 22 days) effectively mitigates fear and thermal stress responses in broiler chickens to unexpected environmental changes without adversely affecting growth performance and stress status [11]. Computer vision has enabled the detection of the impact of environmental alterations (environmental enrichment and temperature) on the locomotion of broiler chickens housed in a controlled climate chamber [19]. Behavioral analysis holds significant potential in developing a remote monitoring system for detecting heat stress in poultry reared in non-enriched environments [20–22]. Therefore, behavioral analysis represents a promising and non-invasive tool for estimating the level of animal comfort and welfare.

For an extended period, behavioral responses have predominantly been quantified based on their intensity, frequency, or duration. [23]. The gold standard for video analysis in behavioral research has been the implementation of the ‘scan-sampling’ method by researchers. [24]. On the other hand, the intricate patterns of behavior encompassing directional, sequential, and temporal organization have been largely disregarded and underestimated. [23]. Nevertheless, research

interests are progressively shifting towards analyzing more intricate behavioral patterns. [23,25–27]. The research by [28] indicated that the complexity of locomotive sequences diminished under stress, while the complexity of behaviors such as perching, foraging, and resting increased in enriched conditions. [25] chickens can sustain a consistent behavioral pattern during rearing, characterized by individual rather than flock-based rhythms, as evidenced by their spatial utilization within the barn. Such distinct rhythmic behavior indicates an organism's health [29]. Existing literature recognizes that stressors can disrupt behavioral rhythms [29–33]. Consequently, detecting recurrent behavioral patterns over time can be crucial for evaluating breeding practices and animal welfare. The Generalized Sequential Pattern (GSP) algorithm is a data mining method that identifies recurring sequences surpassing a user-specified support threshold, initially developed by [34] to understand customer behavior patterns. The potential of this algorithm for the behavioral profiling of broiler chickens in conditions of thermal comfort and heat stress was investigated by [26,27]. However, its applicability for poultry housed in enriched environments remains unexplored.

This study serves as a proof of concept aimed at validating the application of the GSP algorithm for identifying temporal correlations between heat stress and the behavior of broiler chickens in enriched environments.

## 2. Materials and Methods

### 2.1. Animals, Housing and Management

Twenty-day-old, mixed-sex Cobb® chicks were sourced from a commercial hatchery and transferred to a climate chamber. Twenty chicks of similar weights and balanced sex distribution were selected for housing within a climatic chamber containing three compartments with an independent control system. The compartments and animals were randomly assigned to treatment groups on the first day of housing and divided into two treatments, each comprising ten broilers: one without environmental enrichment and one with environmental enrichment. Experimental testing occurred at 21 and 22 days of age under thermoneutral and heat stress conditions, respectively. This age marks the onset of heat stress that can impair productive performance (reduced feed intake and weight gain) and adversely challenge animal metabolism and immunity ([35–37].

Neither compartment contained environmental enrichment objects during the initial acclimatization period (the first three days) in the climate chamber. The broilers were encouraged to consume food and water. From the fourth day onward, the compartment designated as “enriched” was provided with colored plastic rings suspended by a string, a plastic box containing fine sand, and a wooden perch designed to positively stimulate the species' natural behaviors (perching, pecking, and dust bathing) ([38–40]. The enrichment objects were rearranged within the system every three days, following the methodology proposed by [10], to promote exploratory behavior and prevent loss of interest by the animals.

Each compartment, measuring (1.6m x 1.4m) was equipped with an air conditioner, two dehumidifiers, two heaters, a dimmable LED lamp to control light intensity (lux), and a video camera. Throughout the experimental period, water and commercial feed were provided ad libitum, adhering to the nutritional recommendations suggested by [41]. Each compartment contained a manual tubular feeder and an automatic tubular drinker with height adjustment. Daily morning management included cleaning the floor and the drinker, and feed was weighed and distributed into the feeders by the same personnel. The floor was covered with bedding made of wood shavings (0.05 m). The lighting schedule followed company recommendations, with 24-hour light until day 7, followed by an increase of one hour of darkness every two days, so that by day 14, the broilers were subjected to a photoperiod of 20 hours of light and 4 hours of darkness, from 21:00 h to 01:00 h, until the end of the rearing period at 42 days of age. The adopted illuminance followed the recommendation of 20 lx measured at the height of the birds and was gradually reduced to 5 to 10 lx until the end of housing. [42]. The environmental control equipment was automatically activated (turned on and off) according to the temperature and humidity levels set by the user. Relative humidity was programmed to remain at 60% continuously [42], with only air temperature varying during the experimental period. The automated control system was demonstrated to maintain distinct set-point temperatures and

required one hour to stabilize at the desired temperature [43]. Figure 1 [19] shows the positioning of all the equipment used in the climate chamber and the technical support room during the experimental period.

During the initial twenty-one days of housing, the broiler chickens were kept in thermoneutral conditions. On the twenty-second day, they were exposed to heat stress (30°C) for a continuous seven-hour period from 12:00 to 18:00 h, following the standards set by the Cobb breeding manual [42].

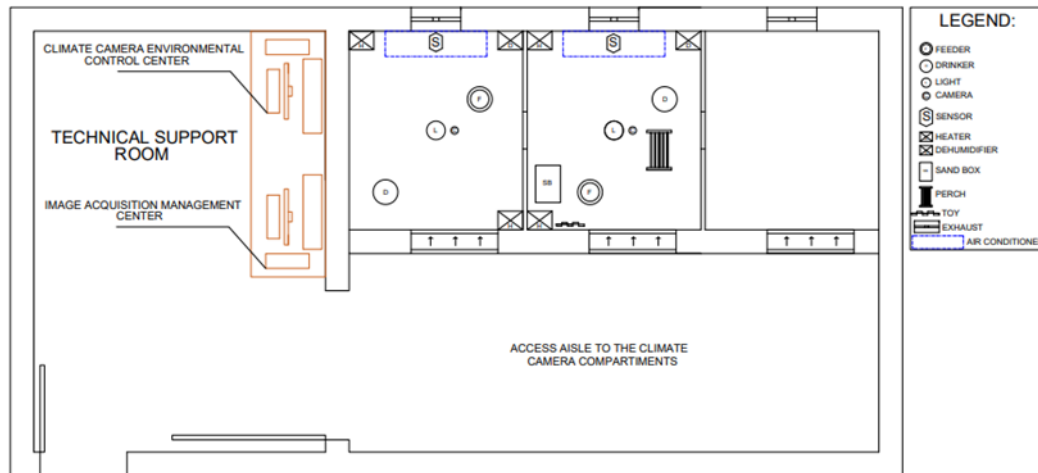

**Figure 1.** Plan view of the environmental chamber [19].

## 2.2. Image Acquisition

Surveillance cameras (Intelbras® VMD 3120 IR, Intelbras Corporation, São José, Santa Catarina, Brazil) were employed for the acquisition and subsequent analysis of animal behavior data. These devices offer a resolution of 976 x 496 (H x V) and are equipped with an infrared feature that activates automatically under low-light conditions. The cameras were mounted on the ceiling at the geometric center of each compartment. Figure 2 shows the unenriched (A) and enriched (B) compartments.

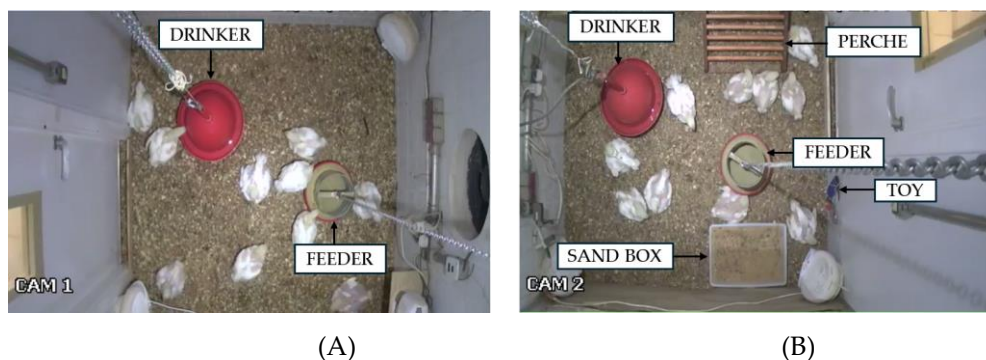

**Figure 2.** Top view of the unenriched (a) and enriched (b) compartments.

Data collection occurred through video recordings captured between 12:00 and 18:00 h. The recordings were then automatically archived on an NVR video recorder (Intelbras® Multi HD Serie 1000, 1080p, Intelbras Corporation, São José, Santa Catarina, Brazil). Video image collection was conducted automatically for 48 consecutive hours, with an analysis of a continuous seven-hour period from 12:00 to 18:00 for two consecutive days of testing. The final dataset consisted of one behavioral attribute that could take on 13 different values (Table 1), encompassing basic behaviors derived from previous studies on the behavior and welfare of broiler chickens in both non-enriched and enriched environments.

**Table 1.** The descriptive ethogram of broiler chicken behaviors applied to compile the database.

| Behavior        | Acronym | Description   | Reference |
|-----------------|---------|---|-----------|
| Lying down      | Ld      | Broilers with the ventral body region in contact with the ground, knees bent, and with either closed or open eyes (resting).                                      | [44]      |
| Preening        | P       | Broilers were pecking or scratching their feathers in both seated and standing positions.   | [45]      |
| Forage          | F       | Broilers stretch their necks and peck at the substrate on the ground in both sitting and standing positions.  | [15]      |
| Walk            | W       | Broilers walk at least two steps without pecking at the ground.   | [45]      |
| Wing flap       | Wf      | The broiler is repeatedly seen flapping its wings.  | [47]      |
| Shake feathers  | Sf      | Broiler ruffling and shaking all feathers of the body.  | [44]      |
| Eat             | E       | The broiler's head is positioned within the feeder, encompassing slight movements around the perimeter of the feeder.   | [45]      |
| Drink           | D       | The broiler's beak is in contact with the drinker, including slight movements around the drinker.   | [45]      |
| Run             | R       | The broiler achieves a higher ground speed when the propulsive force is derived from leg action.  | [47]      |
| Stretching      | St      | The broiler stretches one or two wings or legs and returns to its original position.  | [15]      |
| Lying laterally | Ll      | Broiler lying on its side with one leg and/or wing stretched out  | [15]      |
| Dust bathing    | Db      | The broiler is lying on the ground, throwing dirt on its back/wings, ruffling, and shaking its feathers.  | [46]      |
| Explore         | Ex      | Broiler explores the environment by interacting with objects. Exclusive to the enriched environment, including pecking perch, sandbox, and colorful plastic rings | [11]      |

The analysis of behavioral time series necessitates the utilization of uninterrupted datasets, as the unique response patterns of each subject may provide novel insights into an animal's condition [23]. The current study involved video recordings of 30-minute durations, with a focused examination of the initial 10 minutes, segmented into two 5-minute intervals for continuous analysis. Our research further sought to evaluate the precision of the Generalized Sequential Pattern (GSP) algorithm within this abbreviated timeframe, a context not previously explored in the scientific literature. Previous research by [26] and [27] identified temporal sequences using the GSP algorithm during a continuous 15 and 10-minute analysis, respectively.

Behavioral transitions were identified when an avian subject exhibited a specific activity for at least 10 seconds before switching to a distinct behavior [27,39,47]. On each assessment day, under usual and heat stress conditions, we observed 140 behavioral events for each broiler (n=10), corresponding to uninterrupted behavioral observations. These were segmented into 14 video clips, each 5 minutes in length. The recorded behaviors were subsequently sequenced and analyzed using Weka® software, which executed the sequential pattern mining tasks, such as the Generalized

Sequential Pattern (GSP) algorithm. This software is a comprehensive platform combining algorithms from diverse methodologies within the subfield of artificial intelligence, mainly focusing on machine learning applications [48]. Figure 3 illustrates the diagram of activities used in data collection for proof of concept validation.

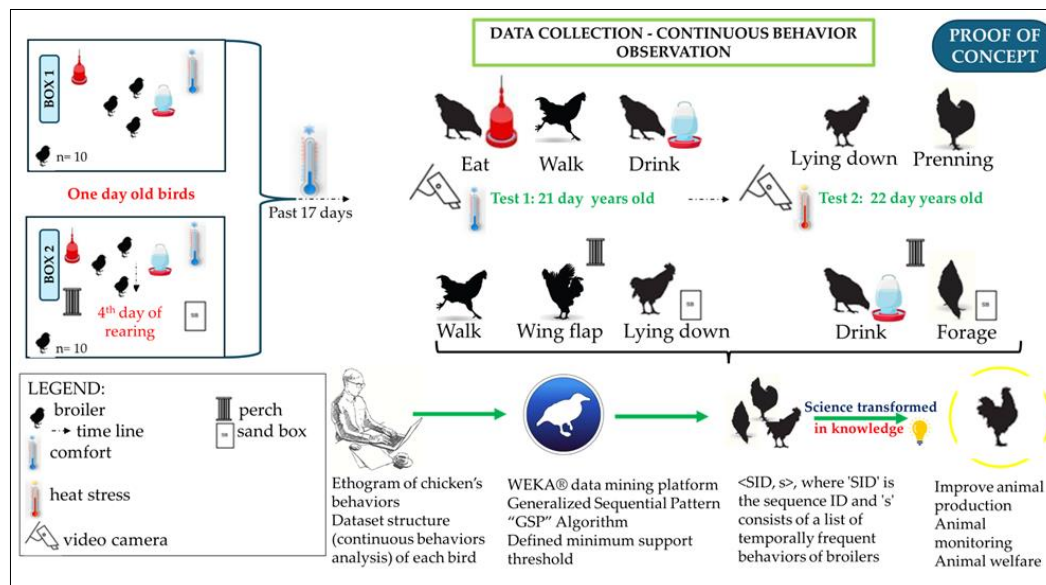

Figure 3. Schematic of the methodology used for proof-of-concept tests.

### 2.3. Generalized Sequential Pattern (GSP) Algorithm

Sequential pattern mining is employed for predictive analysis in data mining [49]. The GSP algorithm, created and implemented by [34], is intended to unearth patterns frequently occurring over time within databases, adhering to a user-determined minimum support level. Therefore, supporting a sequential pattern equates to the fraction of data sequences that encapsulate the pattern. However, each item within a sequence pattern must co-occur within a single transaction for the data sequence to validate the pattern [34]. For instance, the algorithm conducts several passes over the data set. The initial pass assesses the support of each item – that is, it counts the data sequences containing the item and identifies which items are frequent and meet the threshold of minimal support. These items, in turn, each generate a single-element frequent sequence. Following this, each subsequent pass is initiated with a set of seeds, the frequent sequences discovered in the prior pass. This seed set is then employed to cultivate new candidate sequences, potentially frequent, each augmented by one additional item. The support for these candidate sequences is gauged during the pass through the data. At the end of the cycle, the algorithm ascertains which candidate sequences are frequent, establishing them as seeds for the ensuing pass. The algorithm concludes its process when no frequent sequences are detected at the close of a pass or when no new candidate sequences are generated [34,49].

A comprehensive exploration of the fundamental principles of sequence pattern mining is elaborated upon in several studies [34,50–52]. By utilizing a user-defined minimum support threshold (minsup), the Generalized Sequential Pattern (GSP) algorithm seeks to identify all subsequences within a sequence database that meet or exceed this threshold [52].

The support of a sequence is quantified using Equation (1), which establishes the basis for evaluating the frequency of subsequence occurrences relative to the total dataset.

$$\text{support}(s) = \frac{|\text{Number of occurrences } S|}{|\text{Total of sequence in the data set}|} \rightarrow [0; 1] \quad (1)$$

Table 2 illustrates data construction on sequential patterns in broiler chickens using the Generalized Sequential Pattern (GSP) algorithm. The Sequence-Id (SID) corresponds to the

identification of each sampled chicken (e.g., broiler1, broiler2... to broiler). The time transaction records observations according to user-defined temporal criteria (1st, 2nd, 3rd...). Behaviors are denoted by the frequency of their occurrence within the analyzed minutes and constitute the items in the sequence. The number of items within a sequence defines its length. The data prepared for analysis in the data mining platform comprises tuples formatted as <SID, s>, where 'SID' is the sequence ID and 's' consists of a list of temporally ordered behaviors of broiler chickens.

In the example (Table 2), we have SID (broiler1) = < Eat (E), Walk (W), Drink (D)>, which has a size of 3 and means that these behaviors occurred in this chronological order. The minimum support value established as a criterion by the user will determine whether this sequence is frequent or not in the database. Agrawal and Srikant [34] pioneered developing and validating the GSP algorithm, which was designed to understand customer purchasing behavior in commercial retail. They used a minimum support threshold (minsup) of 5% to find frequent sequential patterns in a specific database. Prior research [26,27] investigating the sequential behavior of broiler chickens in unenriched environments under varying thermal conditions utilized minimum support thresholds of 25% and 40%, respectively, within their Generalized Sequential Pattern (GSP) analyses. The present study used a 20% threshold, the best-performing threshold for evaluating the sequential pattern of broiler chickens housed in an enriched environment. The support value of any sequence reveals how frequent that sequence is.

**Table 2.** Example of Database for Analyzing Sequential Behavioral Patterns in Broiler Chickens.

| Data base <i>D</i> |                  |                 |
|--------------------|------------------|-----------------|
| Sequence-Id        | Transaction Time | Items           |
| broiler1           | 1 <sup>a</sup>   | Eat (E)         |
| broiler1           | 2 <sup>a</sup>   | Walk (W)        |
| broiler1           | 3 <sup>a</sup>   | Drink (D)       |
| broiler2           | 1 <sup>a</sup>   | Lying down (Ld) |
| broiler2           | 2 <sup>a</sup>   | Prepping (P)    |

### 3. Results and Discussion

Table 3 presents the frequent behavioral patterns for broiler chickens aged 21 days (third week) reared in an unenriched and enriched environment under comfortable temperatures. Table 4 inserts the frequent behavioral patterns for broiler chickens at 22 days reared in an unenriched and enriched environment under heat stress. As the MinSupport value is reduced, new sequences are found, and the results (sequences) of the previous supports are excluded from the tables because they are identical subsets at the higher level. This pruning reduces repetitiveness and facilitates the reader's analysis.

**Table 3.** Sequential behavioral patterns of broiler chickens in non-enriched and enriched environments under thermoneutral conditions.

| Broilers housed in a non-enriched environment |   |   |
|---|---|---|
| MinSupport                                    | Sequence number                           | Sequence  |
| 1.0, 0.9 e 0.8                                | 1 size 1                                  | <{Ld,P}> (n=10)   |
| 0.7 e 0.6                                     | 1 size 1 and 1 size 2                     | <{Ld,F}> (n=7); <{Ld,P} {Ld,P}> (n=7)   |
| 0.5   | 1 size 2                                  | <{Ld,F} {Ld,P}> (n=5)   |
| 0.4   | 1 size 2                                  | <{Ld,P} {Ld,F}> (n=4)   |
| 0.3   | 2 size 1 and 1 size 3                     | <{P,F,P}> (n=3); <{Ld,P,F}> (n=3); <{Ld,P} {Ld,P} {Ld,P}> (n=3)   |
| 0.2   | 4 size 1, 8 size 2, 6 size 3 and 1 size 4 | <{E,W,F}> (n=2); <{W,F,P}> (n=2); <{D,W,E}> (n=2); <{F,P,W,E}> (n=2); <{Ld,P} {Ld,P,F}> (n=2); <{Ld,P} {D,W,E}> (n=2); <{P,F,P} {Ld,P}> (n=2); <{P,F,P} {Ld,F}> (n=2); <{Ld,F} {Ld,P,F}> (n=2); |

| Broilers housed in an enriched environment |  |   |
|--|--|---|
| MinSupport                                 | Sequence number                            | Sequence  |
| 1.0 a 0.8                                  | None                                       | <{Ld,F} {D,W,E}> (n=2); <{Ld,P,F} {Ld,P}> (n=2); <{W,F,P} {Ld,P}> (n=2); <{Ld,P} {Ld,P} {Ld,F}> (n=2); <{Ld,P} {Ld,F} {Ld,P}> (n=2); <{P,F,P} {Ld,P} {Ld,P}> (n=2); <{P,F,P} {Ld,P} {Ld,F}> (n=2); <{Ld,F} {Ld,P} {Ld,P}> (n=2); <{Ld,F} {Ld,P} {Ld,P,F}> (n=2); <{P,F,P} {Ld,P} {Ld,F} {Ld,P}> (n=2)   |
| 0.7 e 0.6                                  | 1 size 1                                   | <{Ld,P}> (n=7)  |
| 0.5  | 2 size 1                                   | <{Ld,P,F,P}> (n=5); <{Ld,P,F}> (n=5)  |
| 0.4  | 1 size 1                                   | <{F,P}> (n=4)   |
| 0.3  | 3 size 1 and 2 size 2                      | <{P,F,P}> (n=3); <{P,Ld}> (n=3); <{Ld,F,P}> (n=3); <{Ld,P} {Ld,P,F,P}> (n=3); <{Ld,P,F,P} {Ld,P,F,P}> (n=3)   |
| 0.2  | 4 size 1, 11 size 2, 4 size 3 and 1 size 4 | <{Ld,F,P,F}> (n=2); <{Ld,F}> (n=2); <{Ld,P,Sf,P}> (n=2); <{E,W,F}> (n=2); <{Ld,P} {Ld,F}> (n=2); <{Ld,P} {Ld,F,P}> (n=2); <{F,P} {Ld,P,F,P}> (n=2); <{Ld,P,F,P} {Ld,F}> (n=2); <{P,F,P} {Ld,P}> (n=2); <{P,F,P} {Ld,P,F,P}> (n=2); <{Ld,F} {Ld,F}> (n=2); <{P,Ld} {Ld,P}> (n=2); <{P,Ld} {Ld,P,F}> (n=2); <{E,W,F} {F,P}> (n=2); <{Ld,P,F} {Ld,P}> (n=2); <{Ld,P} {Ld,F} {Ld,F}> (n=2); <{Ld,P} {Ld,P,F,P} {Ld,P,F,P}> (n=2); <{Ld,P} {Ld,P,F,P} {Ld,F}> (n=2); <{Ld,P,F,P} {Ld,F} {Ld,F}> (n=2); <{Ld,P} {Ld,P,F,P} {Ld,F} {Ld,F}> (n=2) |

n = number of broilers performing the described behavior with a support value of 20%. Legend behaviours: Ld= lying down; P= preening; F= forage; E= eat; D= drink; W= walk; Sf= shake feathers.

**Table 4.** The sequential behavioral pattern of broiler chickens housed in a non-enriched and enriched environment under heat stress conditions.

| Broilers housed in a non-enriched environment |                       |  |
|---|-----------------------|--|
| MinSupport                                    | Sequence number       | Sequence   |
| 1.0 a 0.5                                     | None                  |  |
| 0.4   | 1 size 1              | <{Ld,P,W,D,W}> (n=4)   |
| 0.3   | 2 size 1              | <{Ld,P}> (n=3); <{Ld,F,P}> (n=3)   |
| 0.2   | 3 size 1 and 1 size 2 | <{Ld,P,F}> (n=2); <{Ld,P,St,Ll}> (n=2); <{E,W,P,W,F}> (n=2); <{Ld,P,St,Ll} {Ld,P,W,D,W}> (n=2)   |
| Broilers housed in an enriched environment    |                       |  |
| MinSupport                                    | Sequence number       | Sequence   |
| 1.0 a 0.4                                     | None                  |  |
| 0.3   | 1 size 1              | <{E,W,F}> (n=3)  |
| 0.2   | 6 size 1 and 1 size 2 | <{Ld,F}> (n=2); <{Ld,W,D}> (n=2); <{Ld,P,W,P}> (n=2); <{E,W,D}> (n=2); <{P,F,St,P}> (n=2); <{E,F,E}> (n=2); <{P,F,St,P} {E,W,F}> (n=2) |

n = number of broilers performing the described behavior with a support value of 20%. Legend behaviours: Ld= lying down; P= preening; F= forage; E= eat; D= drink; W= walk; St= stretching; Ll= lying laterally.

Of all the behavioral possibilities described and considered in the ethogram of Table 1, four out of the total of 13 behaviors were not observed (frequent) at the 20% support (Run, Dust bathing,

Explore, and Wing flap). This result may be rooted in some relevant aspects, either in isolation or combination. Factors that explain our results include specificities involving the tool (the operational aspect of the GSP algorithm that requires the behavior frequency to occur in the chronological order in which they appeared) [34,50]; particularities inherent to the behavior itself such as low frequency (rare events); characteristics related to the individual; and also the bias of chance ("error" of uncontrolled origin).

The comfort temperature resulted in a more significant number of behavioral patterns compared to heat stress. The number of patterns found between the treatments was similar under thermoneutral conditions (27 non-enriched vs. 29 enriched) and heat stress conditions (7 non-enriched vs. 8 enriched). Sequence sizes ranging from 1 to 4 were identified in both rearing environments under thermoneutrality. The size 4 sequence in the non-enriched environment shows that the broiler performed the behaviors in chronological order according to the analysis criterion (during 5 continuous minutes) <{P,F,P} - 1 step {Ld,P} - 2 step {Ld,F} - 3 step {Ld,P} - 4 step>. In the enriched environment, the size 4 sequence involved the same behaviors but in a different chronological order <{Ld,P} - 1 step {Ld,P,F,P} - 2 step {Ld,F} - 3 step {Ld,F} - 4 step>. However, the ambient temperature above the comfort zone restricted the sequence sizes to a maximum of 2. Heat stress drastically reduced the number of pattern sequences of broilers in both tested situations, reducing the level of activity and movement [17,19–22,26,27,44]. [28] studied broilers in an enriched environment and established that the fractal complexity of the behavior sequence decreased with increased heat stress due to insufficient energy to perform complex behaviors.

The sequence <{Ld,P}> was the first behavioral pattern found in both treatments (non-enriched and enriched) under comfort temperature and heat stress only in broilers housed in a non-enriched environment. Branco et al. [26] also observed this same sequential pattern in broilers of the same age (21 days) in non-enriched and thermoneutral situations. The most frequent behavior in the sequential patterns was Ld (Lying down), mainly under comfort temperature. Broilers spend an average of 76–80% of their time lying down [53], which predisposes them to locomotor problems (lesions and fractures) due to poor movement [15,54]. Lameness, long periods of lying down, and other health problems will likely interfere with the broilers' ability to perform high-priority behaviors [55], such as foraging, comfort, and dust bathing [56]. Preening is a natural broiler behavior, highly motivated and indicative of comfort [53,54], although it may be more present in thermal stress environments [26]. Specifically, for this research, comfort behaviors considered were preening (P), dust bathing (Db), shaking feathers (Sf), and stretching (Sf) [55]. Foraging (F) and exploring (Ex) behaviors are classified as exploratory behavior [55], being essential and considered healthy for the broiler. Our sequence pattern results identified a high prevalence of "Ld", "P", and "F" in the sequence formation in both treatments, indicating strong motivation and priority from the animal's perspective. Broilers in comfort temperature have high motivation to perform these last mentioned behaviors, whose sequences <{Ld,P}>; <{Ld,F}>; <{P,F,P}>; <{Ld,P,F}> and <{E,W,F}> were the only ones observed in both treatments. All other sequential patterns (comfort and stress) were distinct, suggesting that environmental enrichment alters the behavioral pattern of broilers.

The walking behavior of broilers in thermoneutrality was more directly related to feeding (eating and drinking) and exploration activities (foraging), as observed in the sequences <{E,W,F}>; <{W,F,P}>; <{D,W,E}>; <{F,P,W,E}>. Broilers explore the environment in search of food and water even under thermal stress situations, as seen in non-enriched housing <{E,W,P,W,F}>; <{Ld,P,St,Li}> <{Ld,P,W,D,W}> and enriched housing <{E,W,F}>; <{Ld,W,D}>; <{E,W,D}>; <{P,F,St,P}> <{E,W,F}>. In a conventional statistical approach, [57] observed frequencies  $\geq 20\%$  for the behaviors of lying down, walking, eating, drinking, and preening, reinforcing from another perspective the probable connection of locomotor activity behavior related to feeding. Broilers housed in non-enriched environments under heat-stress conditions tend to walk and congregate near the drinker to benefit from the microclimate near the water [19,21,58]. However, in the same situations but in enriched environments, they gather around enrichment objects, indicating that environmental enrichment can minimize the negative effect of thermal stress on the broilers [19]. Rufener et al. [25] investigated behavioral time series in laying hens, revealing that the birds exhibited consistent daily results

specific to each individual's movement and location patterns. In other words, the hens can maintain a relatively stable behavioral rhythm under rearing conditions, following an individual rhythm rather than a flock rhythm, which can be reflected in the use of areas in the barn [25].

In the thermally comfortable and enriched environment, the broiler exhibited the sequence <{Ld,P,Sf,P}>, indicating probable positive well-being, as the behavior "Sf" was not observed in any pattern for broilers in a sterile environment. It should be noted that the more frequent a behavior is, the higher the probability of the GSP algorithm finding a pattern according to chronology and threshold criteria.

The most prominent sequential pattern for broilers raised in environments devoid of environmental enrichment when thermally challenged were: <{Ld,P,St,Ll}> and <{Ld,P,St,Ll}{Ld,P,W,D,W}>. Specifically for the sequence "St,Ll" some critical points should be evaluated. Firstly, the behavior "St" is classified as a comfort behavior for broilers and could be used to assess animal welfare [59]. However, measuring its occurrence in isolation may not be the best way to estimate the welfare status of this animal, and it should be correlated with climatic factors. Thus, an individual signature in temporal behavior patterns could provide a new opportunity to assess an animal's state [23]. Therefore, the chronological context should be specially considered, as the subsequent behavior observed in the sequence of "St" is lying laterally "Ll", which is a strong indicator of heat stress [26] and [27]. In other words, chronologically speaking, if the broiler performs "St" and then immediately lies laterally, the goal of this broiler is to increase the body surface area for heat exchange (dissipation) for thermal relief [26,27,60]. Conversely, we did not observe this "St,Ll" pattern for broilers housed in enriched environments, which may suggest that environmental enrichment provides the animal with better opportunities for adaptation to face stress-inducing challenges, such as heat stress, corroborating [10] and [19].

However, under heat stress in an enriched environment, there was a tendency for a lower prevalence of the Ld behavior. The sequences observed in broilers housed in enriched environments indicated a more active repertoire involving activities such as the sequences: <{Ld,W,D}> (n=2); <{Ld,P,W,P}> (n=2); <{E,W,D}> (n=2); <{P,F,St,P}> (n=2); <{E,F,E}> (n=2); <{P,F,St,P}{E,W,F}>. Various authors reported more significant movement of broilers in environments provided with environmental enrichment [11,15,19,61,62], correlating with a broader range of usual and motivated behaviors [38,63,64] and, therefore, with potentially fewer health and welfare impairments [65].

#### 4. Conclusions

Using the GSP algorithm, we identified behavioral sequences performed by broiler chickens at 21 and 22 days of age. Heat stress drastically reduced the complexity of behaviors expressed over time. Environmental enrichment provided greater behavioral diversity and more complex temporal sequences, suggesting improved welfare compared to thermal comfort results. Our study offers valuable insights for estimating the welfare of broiler chickens through the study of temporal behavioral sequences.

**Author Contributions:** Conceptualization, J.M.M. and D.J.M.; methodology, J.M.M, D.J.M, and T.B.; software, S.R.M.O; validation, S.R.M.O, T.B.; formal analysis, J.M.M, S.R.M.O.; data curation, D.F.P., J.S.G.B; writing—original draft preparation, J.M.M., and D.J.M., and D.F.P.; writing—review and editing, I.A.N., D.F.P., J.S.G.B., and D.J.M.; visualization, I.A.N., D.F.P., and D.J.M.; supervision, D.J.M., D.F.P., and I.A.N.

**Funding:** This research received no external funding.

**Institutional Review Board Statement:** This research was approved by the Ethics Committee on the use of animals in research(CEUA) of the State University of Campinas (UNICAMP) under protocol 4716-1/2017. The study was conducted in a climate chamber in the experimental area of the Thermal Comfort Laboratory of the School of Agricultural Engineering, State University of Campinas (UNICAMP), São Paulo, Brazil.

**Informed Consent Statement:** Informed consent was obtained from all subjects involved in the study.

**Data Availability Statement:** Data will be available upon request.

**Acknowledgments:** The authors are grateful to the School of Agricultural Engineering (FEAGRI/UNICAMP) and State University of Campinas (UNICAMP). The assistance with commissioning tests provided by the research team of Thermal Comfort Lab (LCT I) undergraduate students was greatly appreciated.

**Conflicts of Interest:** The authors declare no conflict of interest.

## References

1. Pocketbook, F.S. World food and agriculture. FAO Rome Italy 2015.
2. Garcia, R.; Aguilar, J.; Toro, M.; Pinto, A.; Rodriguez, P. A systematic literature review on the use of machine learning in precision livestock farming. *Comput. Electron. Agric* **2020**, *179*, 105826.
3. Fernandez, A.P.; Norton, T.; Tullo, E.; Van Hertem, T.; Yossef, A.; Exadaktylos, V.; Vranken, E.; Guarino, M.; Berckmans, D. Real-time monitoring of broiler flock's welfare status using camera-based technology. *Biosyst. Eng* **2018**, *173*, 103–114.
4. Tullo, E.; Fontana, I.; Diana, A.; Norton, T.; Berckmans, D.; Guarino, M. Application note: labelling, a methodology to develop reliable algorithm in PLF. *Comput. Electron. Agric* **2017**, *142*, 424–428.
5. Lee, M.; See, S. Wearable wireless biosensor technology for monitoring cattle: A review. *Animals* **2021**, *11*, 2779.
6. Morota, G.; Ventura, R.V.; Silva, F.F.; Koyama, M.; Fernando, S. C. BIG DATA ANALYTICS AND PRECISION ANIMAL AGRICULTURE SYMPOSIUM: Machine learning and data mining advance predictive big data analysis in precision animal agriculture. *J. Anim. Sci* **2018**, *96*, 1540-1550.
7. Zhuang, X.; Zhang, T. Detection of sick broilers by digital image processing and deep learning. *Biosyst. Eng* **2019**, *179*, 106–116.
8. Jones, R.B. Fear and adaptability in poultry: insights, implications and imperative. *World Poult. Sci. J* **1996**, *52*, 131–174.
9. Newberry, R.C. Environmental enrichment: Increasing the biological relevance of captive environments. *Appl. Anim. Behav. Sci* **1995**, *44*, 229–243.
10. Altan, O.; Seremet, C.; Bayraktar, Ö. The effects of early environmental enrichment on performance, fear and physiological responses to acute stress of broiler. *Arch. fur Geflugelkd* **2013**, *1*, 23–28.
11. Bergmann, S.; Schwarzer, A.; Wilutzky, K.; Louton, H.; Bachmeier, J.; Schmidt, P.; Erhard, M. and Rauch, E. Behavior as welfare indicator for the rearing of broilers in an enriched husbandry environment - A field study. *J. of Vet. Behav* **2017**, *19*, 90-101.
12. De Jong, I.C.; Gunnink, H. Effects of a commercial broiler enrichment programme with or without natural light on behaviour and other welfare indicators. *Animal* **2019**, *13*, 384–391.
13. Cornetto, T., and I. Estevez. Influence of vertical panels on use of space by domestic fowl. *Appl. Anim. Behav. Sci* **2001a**, *71*, 141–153.
14. Cornetto, T., and I. Estevez. Behavior of the domestic fowl in the presence of vertical panels. *Poult. Sci* **2001b**, *80*, 1455–1462.
15. Baxter, M.; Bailie, C. L.; O'Connell, N. E. Evaluation of dustbathing substrate and straw bales as environmental enrichments in commercial broiler housing. *Appl. Anim. Behav. Sci* **2018**, *200*, 78-85.
16. Madkour, M.; Aboelenin, M. M.; Younis, E.; Mohamed, M. A.; Hassan, H.; Alagawany, M.; Shourrap, M. Hepatic acute-phase response, antioxidant biomarkers and DNA fragmentation of two rabbit breeds subjected to acute heat stress. *Ital. J. of Anim. Sci* **2020**, *19*, 1568–1576.
17. Lara, L.J.; Rostagno, M.H. Impact of Heat Stress on Poultry Production. *Animals* **2013**, *3*, 356-369.
18. Xin, H. Assessing swine thermal comfort by image analysis of postural behaviors. *J. Anim. Sci* **1999**, *77*, 1–9.
19. Massari, J. M.; Moura, D. J.; Nääs, I.A.; Pereira, D. F.; Branco, T. Computer-Vision-Based Indexes for Analyzing Broiler Response to Rearing Environment: A Proof of Concept. *Animals* **2022**, *12*, 846.
20. Pereira, D.F.; Miyamoto, B.C.B.; Maia, G.D.N.; Sales, G.T.; Magalhães, M.M.; Gates, R.S. Machine vision to identify broiler breeder behavior. *Comput. Electron. Agric* **2013**, *99*, 194–199.
21. Pereira, D.F.; Lopes, F.A.A.; Filho, L.R.A.G.; Salgado, D.D.A.; Neto, M.M. Cluster index for estimating thermal poultry stress (*Gallus gallus domesticus*). *Comput. Electron. Agric* **2020**, *177*, 105704.
22. Del Valle, J.E.; Pereira, D.F.; Mollo Neto, M.; Gabriel Filho, L.R.A.; Salgado, D.D.A. Unrest index for estimating thermal comfort of poultry broilers (*Gallus gallus domesticus*) using computer vision techniques. *Biosyst. Eng* **2021**, *206*, 123–134.
23. Stachowicz, J.; Nasser, R.; Adrion, F.; Umstätter, C. Can we detect patterns in behavioral time series of cows using cluster analysis? *J. of Dairy Sci* **2022**, *105*, 9971-9981.
24. Mancinelli, A.C.; Trocino, A.; Chiattelli, D.; Ciarelli, C.; Castellini, C. New approaches to selecting a scan-sampling method for chicken behavioral observations and their practical implications. *Sci. Rep* **2023**, *13*, 17177.

25. Rufener, C.; Berezowski, J.; Maximiano Sousa, F.; Abre, Y.; Asher, L.; Toscano, M.J. Finding hens in a haystack: Consistency of movement patterns within and across individual laying hens maintained in large groups. *Sci. Rep* **2023**, *13*, 17177.
26. Branco, T.; Moura, D.J.; Nääs, I.A.; Oliveira, S.R.M. Detection of broiler heat stress by using the generalised sequential pattern algorithm. *Biosyst. Eng* **2020**, *199*, 121–126.
27. Branco, T.; Moura, D.J.; Nääs, I.A.; Lima, N.D.S.; Klein, D.R.; Oliveira, S.R.M. The sequential behavior pattern analysis of broiler chickens exposed to heat stress. *AgriEngineering* **2021**, *3*, 447–457.
28. María, G.A.; Escós, J.; Alados, C.L. Complexity of behavioural sequences and their relation to stress conditions in chickens (*Gallus gallus domesticus*): A non-invasive technique to evaluate animal welfare. *Appl. Anim. Behav. Sci* **2004**, *86*, 93–104.
29. Berger, A.; Scheibe, K.M.; Michaelis, S.; Streich, W.J. Evaluation of living conditions of free-ranging animals by automated chronobiological analysis of behavior. *Behav. Res. Methods Instrum. Comput* **2003**, *35*, 458–466.
30. Harper, D. G.; Tornatzky, W.; Miczek, K.A. Stress induced disorganization of circadian and ultradian rhythms: Comparisons of effects of surgery and social stress. *Physiol. Behav* **1996**, *59*, 409–419.
31. Berger, A. Activity patterns, chronobiology and the assessment of stress and welfare in zoo and wild animals. *Int. Zoo. Yb* **2011**, *45*, 80–90.
32. Veissier, I.; Mialon, M. M.; Sloth, K.H. Short communication: Early modification of the circadian organization of cow activity in relation to disease or estrus. *J. Dairy Sci* **2017**, *100*, 3969–3974.
33. Sarout, B.N.M.; Waterhouse, A.; Duthie, C.A.; Poli, C.E.H.C.; Haskell, M.J.; Berger, A.; Umstätter, C. Assessment of circadian rhythm of activity combined with random regression model as a novel approach to monitoring sheep in an extensive system. *Appl. Anim. Behav. Sci* **2018**, *207*, 26–38.
34. Agrawal, R.; Srikant, R. Mining sequential patterns. In *Proceedings of the Eleventh International Conference on Data Engineering*, Taipei, Taiwan, 6–10 March 1995; pp. 3–14.
35. Andretta, I.; Kipper, M.; Schirmann, G.D.; Franceschina, C.S.; Ribeiro, A.M.L. Modeling the performance of broilers under heat stress. *Poult. Sci* **2021**, *100*, 101338.
36. Siddigui, S. H.; Krang, D.; Park, J.; Khan, M.; Belal, S. A.; Shin, D.; Shim, K. Altered relationship between gluconeogenesis and immunity in broilers exposed to heat stress for different durations. *Poultry Sci* **2021**, *100*, 101274.
37. Hu, H.; Bai, X.; Xu, K.; Zhang, C.; Chen, L. Effect of phloretin on growth performance, serum biochemical parameters and antioxidant profile in heat-stressed broilers. *Poult. Sci* **2021**, *100*, 101217.
38. Nicol, C.J. Effects of environmental enrichment and gentle handling on behaviour and fear responses of transported broilers. *Appl. Anim. Behav. Sci* **1992**, *33*, 367–380.
39. Bizeray, D.; Estevez, I.; Leterrier, C.; Faure, J.M. Effects of increasing environmental complexity on the physical activity of broiler chickens. *Appl. Anim. Behav. Sci* **2002**, *79*, 27–41.
40. Miller, K.A.; Mench, J.A. The differential effects of four types of environmental enrichment on the activity budgets, fearfulness, and social proximity preference of Japanese quail. *Appl. Anim. Behav. Sci* **2005**, *95*, 169–187.
41. Rostagno, S.R.; Albino, L.F.T.; Donzele, J.L.; Gomes, P.C.; Oliveira, R.F.; Lopes, S.C.; Ferreira, A.S.; Barreto, S.L.T.; Euclides, R.F. *Tabelas Brasileiras para Aves e Suínos: Composição de Alimentos e Exigências Nutricionais*, 3rd ed.; UFV: Viçosa, Brazil, 2011; p. 252.
42. Coob – Vantress Brasil, Ltd.a. Manual de manejo de frangos de corte. 2013. Disponível em <www.cobb-vantress.com>.
43. Maia, A.P. de A.; Moura, D.J.; Green, A.R.; Silva, W.T.; Sarubbi, J.; Massari, J.M.; Barbosa, L.V.S. Design and testing of a novel environmental preference chamber. *Comput. Electron. Agric* **2019**, *157*, 23–37.
44. Mohammed, A.A.; Jacobs, J.A.; Murugesan, G.R.; Cheng, H.W. Effect of dietary synbiotic supplement on behavioral patterns and growth performance of broiler chickens reared under heat stress. *Poult. Sci* **2018**, *97*, 1101–1108.
45. Mahmoud, U. T.; Abdel-Rahman, M.A.; Darwish, M.H.A.; Applegate, T.J.; Cheng, H.W. Behavioral changes and feathering score in heat stressed broiler chickens fed diets containing different levels of propolis. *Appl. Anim. Behav. Sci* **2015**, *166*, 98–105.
46. Ventura, B.A.; Siewerd, F.; Estevez, I. Access to Barrier Perches Improves Behavior Repertoire in Broilers. *PLoS ONE* **2012**, *7*, e29826.
47. Roll, V.F.B.; dai Prá, M.A.; Roll, A.A.P.; Xavier, E.G.; Rossi, P.; Ancuti, M.A.; Rutz, F. Influência da altura de comedouros tubulares no comportamento ingestivo de frangos de corte. *Arch. Zootec* **2010**, *9*, 115–122.
48. Witten, I.H.; Frank, E.; Hall, M.A.; Pal, C.J. *Data Mining: Practical Machine Learning Tools and Techniques*, 4th ed.; Morgan Kaufmann: San Francisco, CA, USA, 2016.
49. Bureva, V.; Sotirova, E.; Chountas, P. Generalized Net of the Process of Sequential Pattern Mining by Generalized Sequential Pattern Algorithm (GSP). In *Advances in Intelligent Systems and Computing; Springer Science and Business Media LLC: Berlin/Heidelberg, Germany, 2015; pp. 831–838.*

50. Srikant, R.; Agrawal, R. Mining sequential patterns: Generalizations and performance improvements. In *Transactions on Petri Nets and Other Models of Concurrency XV*; Springer Science and Business Media LLC: Berlin/Heidelberg, Germany, 1996; pp. 1–17.
51. Chu, C.J.; Tseng, V.S.; Liang, T. An efficient algorithm for mining temporal high utility itemsets from data streams. *J. Syst. Softw* **2008**, *81*, 1105–1117.
52. Hu, Y.H.; Wu, F.; Liao, Y.J. An efficient tree-based algorithm for mining sequential patterns with multiple minimum supports. *J. Syst. Softw* **2013**, *86*, 1224–1238.
53. Weeks, C.A.; Danbury, T.D.; Davies, H.C.; Hunt, P.; Kestin, S.C. The behaviour of broiler chickens and its modification by lameness. *Appl. Anim. Behav. Sci* **2000**, *67*, 111–125.
54. Collins, S.; Forkman, B.; Kristensen, H.H.; Sandøe, P.; Hocking, P.M. Investigating the importance of vision in poultry: comparing the behaviour of blind and sighted chickens. *Appl. Anim. Behav. Sci* **2011**, *133*, 60–69.
55. Abeyesinghe, S.M.; Chancellor, N.M.; Hernandez Moore, D.; Chang, Y.M.; Pearce, J.; Demmers, T.; Nicol, C.J. Associations between behaviour and health outcomes in conventional and slow-growing breeds of broiler chicken. *Animal*, **2021**, *15*, 100261.
56. Weeks, C. A.; Nicol, C. J. Behavioural needs, priorities and preferences of laying hens. *Worl. Poult. Sci. J* **2006**, *62*, 296–307.
57. Dawson, L.C.; Widowski, T.M.; Liu, Z.; Edwards, A.M.; Torrey, S. In pursuit of a better broiler: a comparison of the inactivity, behavior, and enrichment use of fast- and slower growing broiler chickens. *Poult Sci* **2021**, *100*, 101451.
58. Mack, L.A.; Felver-Gant, J.N.; Dennis, R.L.; Cheng, H.W. Genetic variations alter production and behavioral responses following heat stress in 2 strains of laying hens. *Poult. Sci* **2013**, *92*, 285–294.
59. Li, G.; Zhao, Y.; Porter, Z.; Purswell, J.L. Automated measurement of broiler stretching behaviors under four stocking densities via faster region-based convolutional neural network. *Animal* **2021**, *15*, 100059.
60. Barbosa Filho, J.A.D.B.; Silva, I.J.O.; Silva, M.A.N.; Silva, C.J.M. Avaliação dos comportamentos de aves poedeiras utilizando sequência de imagens. *Eng. Agríc* **2007**, *27*, 93–99.
61. Nazareno, A.C.; Silveira, R.M.F.; CASTRO JUNIOR, S.L.; SILVA, I.J.O. Fuzzy modelling as an intelligent tool to study animal behaviour: An application to broilers with environmental enrichment. *Appl. Anim. Behav. Sci* **2024**, *270*, 106149.
62. Kells, A.; Dawkins, M.S.; Cortina Borja, M. The effect of a ‘Freedom Food’ enrichment on the behaviour of broilers on commercial farms. *Anim. Welf* **2001**, *10*, 347–356.
63. Bach, M.H.; Tahamtani, F.M.; Pedersen, I.J.; Riber, A.B. Effects of environmental complexity on behaviour in fast-growing broiler chickens. *Appl. Anim. Behav. Sci* **2019**, *219*, 104840.
64. Vasdal, G.; Vas, J.; Newberry, R. C.; Moe, R. O. Effects of environmental enrichment on activity and lameness in commercial broiler production. *J. of Appl. Anim. Welf. Sci* **2019**, *22*, 197–205.
65. Zhao, J.P.; Jiao, H.C.; Jiang, Y.B.; Song, Z.G.; Wang, X.J.; Lin, H. Cool perches improve the growth performance and welfare status of broiler chickens reared at different stocking densities and high temperatures. *Poult. Sci* **2013**, *92*, 1962–1971.

**Disclaimer/Publisher’s Note:** The statements, opinions and data contained in all publications are solely those of the individual author(s) and contributor(s) and not of MDPI and/or the editor(s). MDPI and/or the editor(s) disclaim responsibility for any injury to people or property resulting from any ideas, methods, instructions or products referred to in the content.